

800 Lee Rd – B601 Configuration

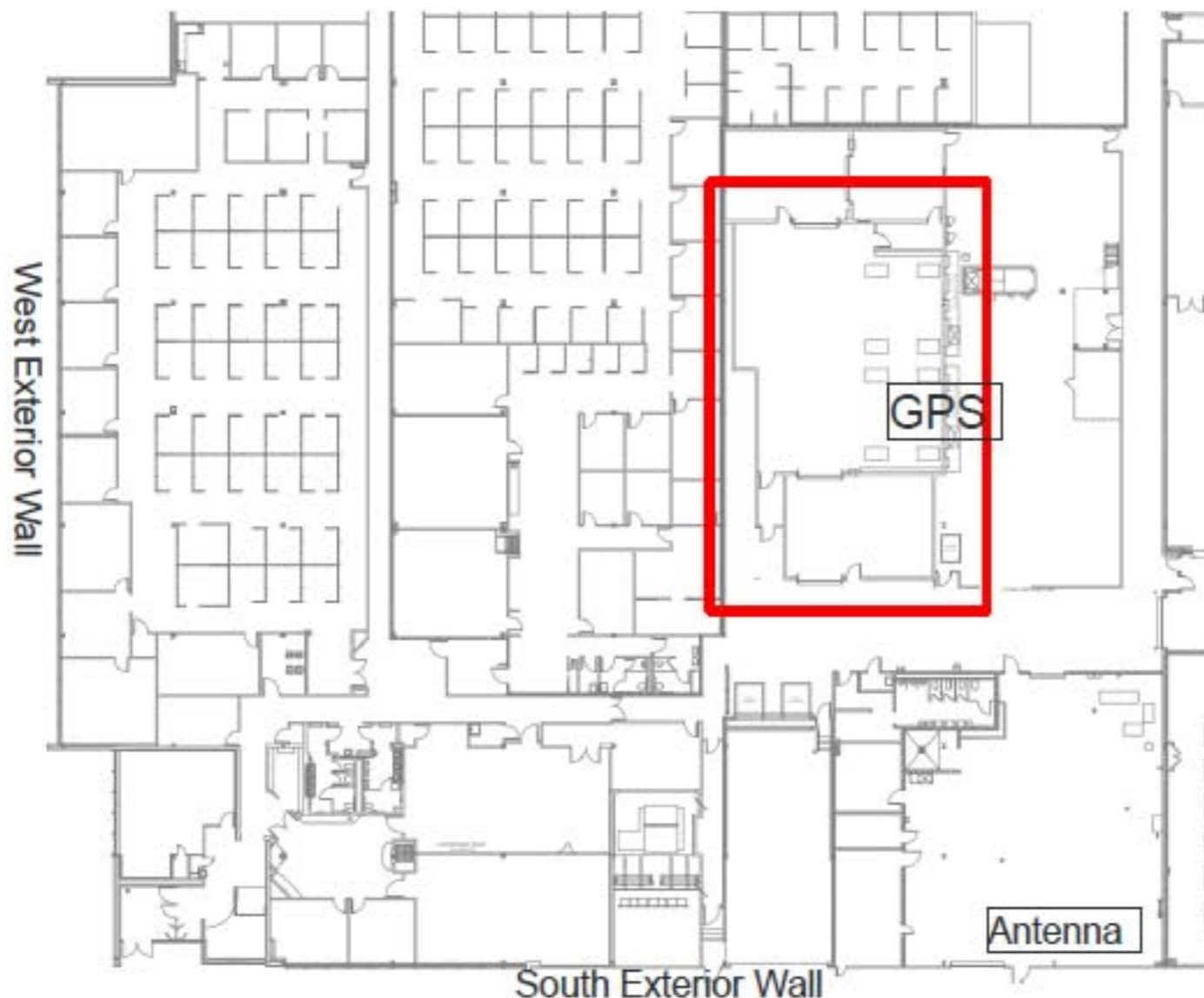

The building area depicted in the sketch is the SW corner of B601. The cleanroom where the repeater is configured is indicated by the red box.

In the red box, the GPS annotation indicates the wall jack inside the cleanroom where the amplifier is located. The repeater antenna is within 15 feet of the amplifier.

The receiving antenna is installed on the building roof as marked.

225 ft. LMR-400 Cable connecting amp and external antenna